

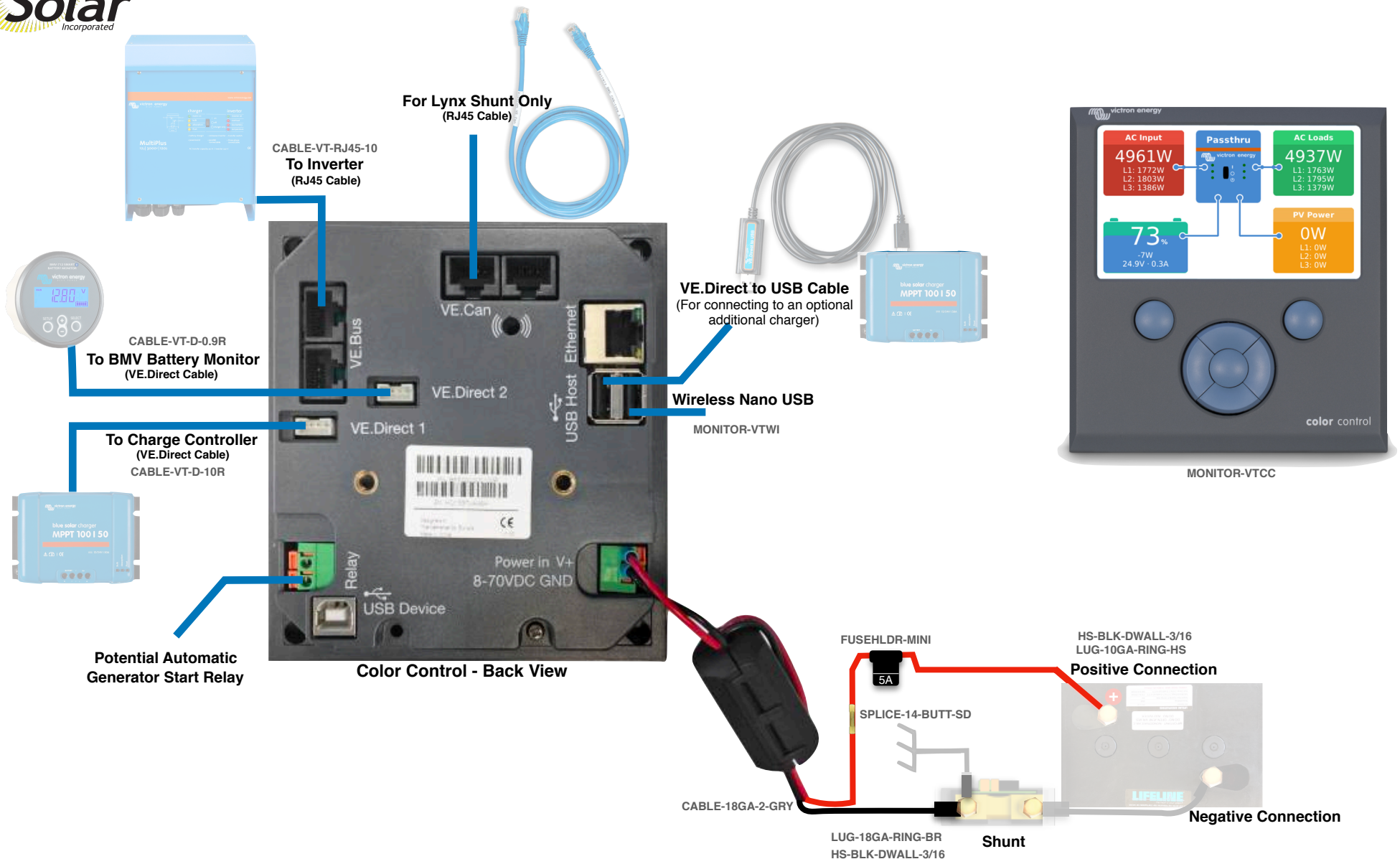

Color Control Wiring



Note: If you do not have the Lynx shunt in your system, you don't need to run an RJ45 cable from the "VE.Can" port as depicted. All the components shown "greyed out" are to show points of connection, and are not included with the Monitor Kit.



Programming Your Victron Color Monitor

Connecting Your Victron Display to Wireless:

1. Press the top right button on the display (menu), and use the down directional button to scroll to Settings. Enter the Settings screen by pressing the center button when “Settings” is highlighted.
2. Use the down directional button to scroll to “Wifi” (near the bottom of the list). Press the center button when highlighted to enter Wifi.
3. Highlight the network you are connecting to, using the up and down directional buttons to scroll if needed. Press the center button to connect once the wireless network is highlighted.

If a password is required, it will prompt you here. Use the up and down directional buttons to select letters. Press the right directional button to move to the next letter. Press the center button when the full password is entered.

4. The connection could take up to 1 minute to complete. Ensure it displays “connected” when done. You now have internet access to your display. Be sure to remain within the wireless signal range during the duration of the firmware upgrade in the next step.

Updating The Display Firmware:

1. Use the left direction button to go back to the “Settings” screen.
2. Use the down directional button to scroll to “Firmware” (2nd down from the top), and press the center button once highlighted.
3. Select “Online updates”. Press the center. Button once highlighted.
4. Select “Check for Updates”. It will proceed with checking for updates.
5. Select “Perform Updates”. It can take up to 5 minutes for the updates to be applied and the system to reboot.
6. It should now display a message stating it’s on the latest version in the “Firmware” section.

Helpful Notes:

- Pressing the center button will always select what is highlighted.
- Pressing the left arrow will take you back to the previous screen.
- Pressing the top right button will pull up the Settings page.



Bottom Directional Button

Top Directional Button



 These devices connect via Bluetooth to communicate with a smartphone using the VictronConnect app.



Recording the VRM Portal ID:

1. Go back to Settings, then enter "VRM Online Portal".
2. Take a photograph of the VRM online portal ID and upload it to the customer's photo folder.

Changing Settings:

1. Go to settings, enter "general", then turn remote support (SSH) on.
2. Take photo or document the remote support port number displayed.
3. Go back to settings, then enter "Remote Console",
4. Select "Disable Password Check".
5. Turn "Enable on VRM" to on.
 1. Ensure you select "No Password Required"
6. Go back to settings, then enter Date and Time and set date/time.
7. Go back to settings, enter "General" then select "reboot?".
8. Enter settings once rebooted, then enter Services and turn on VRM two-way communication.
9. Go to Settings, then enter "System Setup".
 - Change all settings to the following:
 - Log interval: **5 minutes** (1 for troubleshooting)
 - AC Input 1: **Shore Power**
 - AC Input 2: **Generator**
 - Battery Monitor: **Automatic**
 - Synch VE.Bus SOC with battery: **On**
 - Use solar charge current to improve VE.Bus SOC: **On**
 - Has DC System: **On**
 - The following are only visible after the firmware upgrade:
 - DVCC: **On**
 - SVS: **On**
 - Limit Charge Current: **On**
 - Max Charge Current: **300A** (Ensure this number is adequate and safe)



Getting your VRM Portal ID

1. Press the menu button on your Color Control.
2. Go to “Settings”.
3. Go to “VRM Online Portal”.
4. Take a photograph or write down your VRM portal ID shown here. It will be used for later purposes.

Generating A Login:

1. Go to vrm.victronenergy.com from a computer or tablet.
2. Click on the “Register For Free” button.
3. Complete all the fields with your name, etc. except “Company”. Enter AM Solar for the field “Victron Dealer”.
4. Click “Register”.
5. Upon registration, you will get an email sent to the address you entered. The email includes a link to verify your account, click on the link in the email.
6. Once clicking the link in your email to confirm your account, you are now registered. Your browser window should automatically log you into the VRM portal. If it doesn’t automatically log you in, you can visit vrm.victronenergy.com and enter your login credentials.

Adding Your Color Control To Your Portal Account:

1. Click on “Add Installation” in the top left menu.
2. Click on the picture of the Color Control GX.
3. Scroll down to the bottom of the screen, you’ll see a box where you can enter your VRM Portal ID
4. Enter your VRM Portal ID here that you obtained from your Color Control Settings.
5. The device is now always viewable under “Installations” in the top right menu when you login.

VRM Screenshots:

